

丈量図 1 / 2

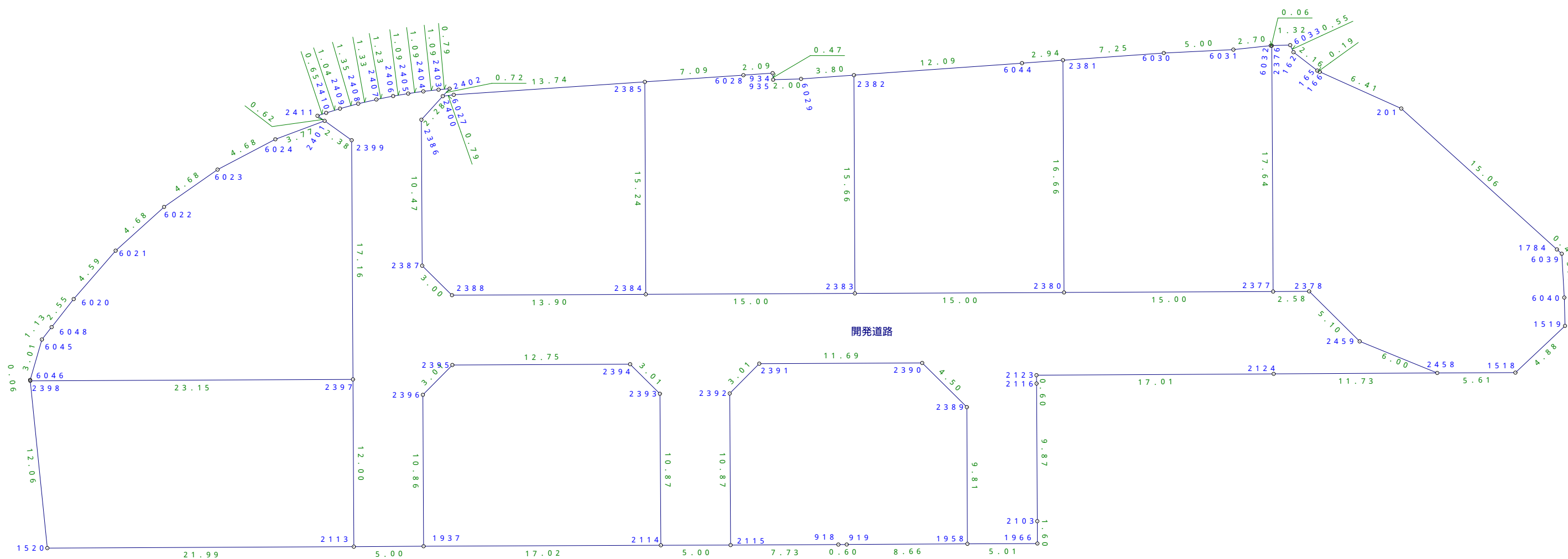

縮尺 300分の1



宅地面積	2270.83㎡
計画道路	668.54㎡
開発区域合計	2939.37㎡

作製：令和 3年 2月 2日
 高松市国分寺町新名440番地9
 土地家屋調査士 西井俊二

丈量図 2 / 2

【許可】

座標求積表

地番				
点名	X	Y	$X_{n+1} - X_{n-1}$	$Y_n (X_{n+1} - X_{n-1})$
2377	141681.654	43060.468	-2.682	-115488.175176
2378	141679.068	43060.480	-6.212	-267491.701760
2459	141675.442	43056.893	-9.191	-395735.903563
2458	141669.877	43054.624	-11.175	-481135.423200
1518	141664.267	43054.654	-9.169	-394768.122526
1519	141660.708	43058.002	-3.506	-150961.355012
6040	141660.761	43060.037	0.235	10119.108695
6039	141660.943	43063.180	0.525	22608.169500
1784	141661.286	43063.489	11.516	495919.139324
201	141672.459	43073.600	17.020	733112.672000
166	141678.306	43076.235	6.025	259534.315875
165	141678.484	43076.325	1.887	81285.025275
162	141680.193	43077.647	1.941	83613.712827
6033	141680.425	43078.155	1.557	67072.687335
2376	141681.750	43078.116	1.229	52943.004564
			倍面積	627.154158 m ²
			面積	313.5770790 m ²
			地積	313.57 m ²

地番				
点名	X	Y	$X_{n+1} - X_{n-1}$	$Y_n (X_{n+1} - X_{n-1})$
2377	141681.654	43060.468	-14.909	-641988.517412
2376	141681.750	43078.116	0.164	7064.811024
6032	141681.818	43078.114	2.755	118680.204070
6031	141684.505	43077.830	7.681	330880.812230
6030	141689.499	43077.585	12.228	526752.709380
2381	141696.733	43077.067	7.160	308431.799720
2380	141696.659	43060.401	-15.079	-649307.786679
			倍面積	514.032333 m ²
			面積	257.0161665 m ²
			地積	257.01 m ²

地番				
点名	X	Y	$X_{n+1} - X_{n-1}$	$Y_n (X_{n+1} - X_{n-1})$
2380	141696.659	43060.401	-14.931	-642934.847331
2381	141696.733	43077.067	3.014	129834.279938
6044	141699.673	43076.856	15.001	646195.916856
2382	141711.734	43075.996	11.991	516524.268036
2383	141711.664	43060.334	-15.075	-649134.535050
			倍面積	485.082449 m ²
			面積	242.5412245 m ²
			地積	242.54 m ²

地番				
点名	X	Y	$X_{n+1} - X_{n-1}$	$Y_n (X_{n+1} - X_{n-1})$
2383	141711.664	43060.334	-14.935	-643106.088290
2382	141711.734	43075.996	3.863	166402.572548
6029	141715.527	43075.725	5.795	249623.826375
935	141717.529	43075.671	2.040	87874.368840
934	141717.567	43076.140	2.133	91881.406620
6028	141719.662	43075.996	9.170	395006.883320
2385	141726.737	43075.513	7.007	301830.119591
2384	141726.669	43060.268	-15.073	-649047.419564
			倍面積	465.669440 m ²
			面積	232.8347200 m ²
			地積	232.83 m ²

地番				
点名	X	Y	$X_{n+1} - X_{n-1}$	$Y_n (X_{n+1} - X_{n-1})$
2384	141726.669	43060.268	-13.839	-595911.048852
2385	141726.737	43075.513	13.778	593494.418114
6027	141740.447	43074.586	14.497	624452.273242
2400	141741.234	43074.488	2.325	100148.184600
2386	141742.772	43072.797	1.481	63790.812357
2387	141742.715	43062.323	-2.196	-94564.861308
2388	141740.576	43060.206	-16.046	-690944.065476
			倍面積	465.712677 m ²
			面積	232.8563385 m ²
			地積	232.85 m ²

地番				
点名	X	Y	$X_{n+1} - X_{n-1}$	$Y_n (X_{n+1} - X_{n-1})$
2399	141747.774	43071.330	2.035	87650.156550
2401	141749.716	43072.715	5.477	235909.260055
6024	141753.251	43071.394	7.680	330788.305920
6023	141757.396	43069.218	7.983	343821.567294
6022	141761.234	43066.537	7.315	315031.718155
6021	141764.711	43063.400	6.487	279352.275800
6020	141767.721	43059.926	4.591	197688.120266
6048	141769.302	43057.918	2.280	98172.053040
6045	141770.001	43057.028	1.541	66350.880148
6046	141770.843	43054.128	0.835	35950.196880
2398	141770.836	43054.061	-23.162	-997218.160882
2397	141747.681	43054.164	-23.062	-992915.130168
			倍面積	581.243058 m ²
			面積	290.6215290 m ²
			地積	290.62 m ²

地番				
点名	X	Y	$X_{n+1} - X_{n-1}$	$Y_n (X_{n+1} - X_{n-1})$
2397	141747.681	43054.164	23.220	999717.688080
2398	141770.836	43054.061	21.931	944218.611791
1520	141769.612	43042.061	-23.220	-999436.656420
2113	141747.616	43042.160	-21.931	-943957.610960
			倍面積	542.032491 m ²
			面積	271.0162455 m ²
			地積	271.01 m ²

地番				
点名	X	Y	$X_{n+1} - X_{n-1}$	$Y_n (X_{n+1} - X_{n-1})$
1937	141742.612	43042.192	-17.075	-734945.428400
2114	141725.590	43042.262	-16.957	-729867.636734
2393	141725.655	43053.135	2.204	94889.109540
2394	141727.794	43055.253	14.892	641178.827676
2395	141740.547	43055.196	14.871	640273.819716
2396	141742.665	43053.057	2.065	88904.562705
			倍面積	433.254503 m ²
			面積	216.6272515 m ²
			地積	216.62 m ²

地番				
点名	X	Y	$X_{n+1} - X_{n-1}$	$Y_n (X_{n+1} - X_{n-1})$
2115	141720.586	43042.277	-7.794	-335471.506938
918	141712.851	43042.314	-8.337	-358843.771818
919	141712.249	43042.317	-9.262	-398657.940054
1958	141703.589	43042.363	-8.620	-371025.169060
2389	141703.629	43052.173	3.245	139704.301385
2390	141706.834	43055.346	14.898	641438.544708
2391	141718.527	43055.294	13.811	594636.665434
2392	141720.645	43053.155	2.059	88646.446145
			倍面積	427.569802 m ²
			面積	213.7849010 m ²
			地積	213.78 m ²

地番	開発道路			
点名	X	Y	$X_{n+1} - X_{n-1}$	$Y_n (X_{n+1} - X_{n-1})$
2378	141679.068	43060.480	6.212	267491.701760
2377	141681.654	43060.468	17.591	757476.692588
2380	141696.659	43060.401	30.010	1292242.634010
2383	141711.664	43060.334	30.010	1292240.623340
2384	141726.669	43060.268	28.912	1244958.468416
2388	141740.576	43060.206	16.046	690944.065476
2387	141742.715	43062.323	2.196	94564.861308
2386	141742.772	43072.797	-1.481	-63790.812357
2400	141741.234	43074.488	-2.025	-87225.838200
2402	141740.747	43075.024	0.308	13267.107392
2403	141741.542	43074.953	1.887	81282.436311
2404	141742.634	43074.834	2.175	93687.763950
2405	141743.717	43074.672	2.164	93213.590208
2406	141744.798	43074.493	2.288	98554.439984
2407	141746.005	43074.246	2.507	107987.134722
2408	141747.305	43073.947	2.605	112207.631935
2409	141748.610	43073.592	2.300	99069.261600
2410	141749.605	43073.288	1.615	69563.360120
2411	141750.225	43073.078	0.111	4781.111658
2401	141749.716	43072.715	-2.451	-105571.224465
2399	141747.774	43071.330	-2.035	-87650.156550
2397	141747.681	43054.164	-0.158	-6802.557912
2113	141747.616	43042.160	-5.069	-218180.709040
1937	141742.612	43042.192	-4.951	-213101.892592
2396	141742.665	43053.057	-2.065	-88904.562705
2395	141740.547	43055.196	-14.871	-640273.819716
2394	141727.794	43055.253	-14.892	-641178.827676
2393	141725.655	43053.135	-2.204	-94889.109540
2114	141725.590	43042.262	-5.069	-218181.226078
2115	141720.586	43042.277	-4.945	-212844.059765
2392	141720.645	43053.155	-2.059	-88646.446145
2391	141718.527	43055.294	-13.811	-594636.665434
2390	141706.834	43055.346	-14.898	-641438.544708
2389	141703.629	43052.173	-3.245	-139704.301385
1958	141703.589	43042.363	-8.620	-371025.169060
1966	141698.571	43042.386	-5.012	-215728.438632
2103	141698.577	43043.991	0.057	2453.507487
2116	141698.628	43053.868	0.054	2324.908872
2123	141698.631	43054.467	-17.013	-732485.647071
2124	141681.615	43054.560	-28.754	-1237990.818240
2458	141669.877	43054.624	-6.173	-265776.193952
2459	141675.442	43056.893	9.191	395735.903563
			倍面積	1337.080483 m ²
			面積	668.5402415 m ²
			地積	668.54 m ²

作製：令和 3年 2月 2日
高松市国分寺町新名440番地9
土地家屋調査士 西井俊二

丈量図 縮尺300分の1

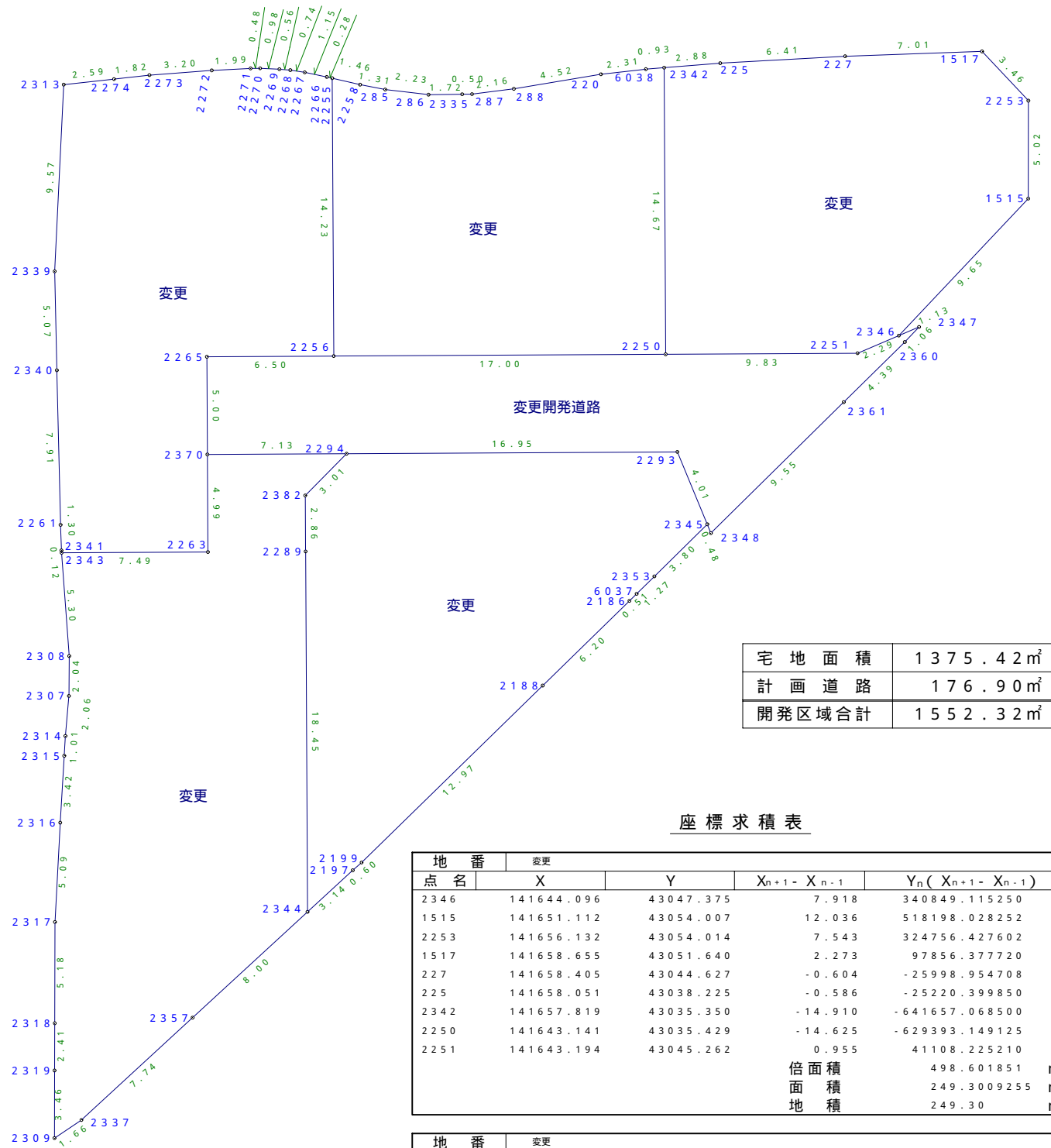
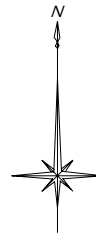

座標求積表

地番	変更	点名	X	Y	X _{n+1} - X _{n-1}	Y _n (X _{n+1} - X _{n-1})		
2346			141644.096	43047.375	7.918	340849.115250		
1515			141651.112	43054.007	12.036	518198.028252		
2253			141656.132	43054.014	7.543	324756.427602		
1517			141658.655	43051.640	2.273	97856.377720		
227			141658.405	43044.627	-0.604	-25998.954708		
225			141658.051	43038.225	-0.586	-25220.399850		
2342			141657.819	43035.350	-14.910	-641657.068500		
2250			141643.141	43035.429	-14.625	-629393.149125		
2251			141643.194	43045.262	0.955	41108.225210		
倍面積							498.601851	m ²
面積							249.3009255	m ²
地積							249.30	m ²

地番	変更	点名	X	Y	X _{n+1} - X _{n-1}	Y _n (X _{n+1} - X _{n-1})		
2250			141643.141	43035.429	14.771	635676.321759		
2342			141657.819	43035.350	14.603	628445.216050		
6038			141657.744	43034.414	-0.337	-14502.597518		
220			141657.482	43032.115	-1.007	-43333.339805		
288			141656.737	43027.648	-1.017	-43759.118016		
287			141656.465	43025.505	-0.278	-11961.090390		
2335			141656.459	43025.001	-0.026	-1118.650026		
286			141656.439	43023.276	0.242	10411.632792		
285			141656.701	43021.057	0.514	22112.823298		
2258			141656.953	43019.767	0.580	24951.464860		
2255			141657.281	43018.342	-13.905	-598170.045510		
2256			141643.048	43018.420	-14.140	-608280.458800		
倍面積							472.158694	m ²
面積							236.0793470	m ²
地積							236.07	m ²

【変更後】

地番	変更	点名	X	Y	X _{n+1} - X _{n-1}	Y _n (X _{n+1} - X _{n-1})		
2256			141643.048	43018.420	14.268	613786.816560		
2255			141657.281	43018.342	14.297	615033.235574		
2266			141657.345	43018.063	0.299	12862.400837		
2267			141657.580	43016.934	0.348	14969.893032		
2268			141657.693	43016.193	0.162	6968.623266		
2269			141657.742	43015.633	0.093	4000.453869		
2270			141657.786	43014.647	0.042	1806.615174		
2271			141657.784	43014.158	-0.106	-4559.500748		
2272			141657.680	43012.166	-0.347	-14925.221602		
2273			141657.437	43008.974	-0.445	-19138.993430		
2274			141657.235	43007.161	-0.485	-20858.473085		
2313			141656.952	43004.583	-9.845	-423380.119635		
2339			141647.390	43004.118	-14.633	-629279.258694		
2340			141642.319	43004.230	-12.987	-558495.935010		
2261			141634.403	43004.420	-9.223	-396629.765660		
2341			141633.096	43004.465	-1.431	-61539.389415		
2343			141632.972	43004.475	-0.083	-3569.371425		
2263			141633.013	43011.974	5.037	216651.313038		
2370			141638.009	43011.947	10.000	430119.470000		
2265			141643.013	43011.920	5.039	216737.064880		
倍面積							559.857526	m ²
面積							279.9287630	m ²
地積							279.92	m ²

地番	変更	点名	X	Y	X _{n+1} - X _{n-1}	Y _n (X _{n+1} - X _{n-1})		
2344			141614.582	43017.078	23.875	1027032.737250		
2289			141633.040	43016.978	21.327	917423.089806		
2382			141635.909	43016.960	5.008	215428.935680		
2294			141638.048	43019.079	2.100	90340.065900		
2370			141638.009	43011.947	-5.035	-216565.153145		
2263			141633.013	43011.974	-5.037	-216651.313038		
2343			141632.972	43004.475	-5.327	-229084.838325		
2308			141627.686	43004.867	-7.332	-315311.684844		
2307			141625.640	43004.849	-4.099	-176276.876051		
2314			141623.587	43004.667	-3.069	-131981.323023		
2315			141622.571	43004.610	-4.438	-190854.459180		
2316			141619.149	43004.404	-8.510	-365967.478040		
2317			141614.061	43004.137	-10.275	-441867.507675		
2318			141608.874	43004.125	-7.604	-327003.366500		
2319			141606.457	43004.113	-5.881	-252907.188553		
2309			141602.993	43004.111	-2.537	-109101.429607		
2337			141603.920	43005.490	6.172	265429.884280		
2357			141609.165	43011.191	10.662	458585.318442		
倍面積							667.413377	m ²
面積							333.7066885	m ²
地積							333.70	m ²

地番	変更	点名	X	Y	X _{n+1} - X _{n-1}	Y _n (X _{n+1} - X _{n-1})		
2345			141634.433	43037.560	6.375	274364.445000		
2293			141638.140	43036.029	3.615	155575.244835		
2294			141638.048	43019.079	-2.231	-95975.565249		
2382			141635.909	43016.960	-5.008	-215428.935680		
2289			141633.040	43016.978	-21.327	-917423.089806		
2344			141614.582	43017.078	-16.327	-702339.832506		
2197			141616.713	43019.395	2.527	108710.011165		
2199			141617.109	43019.849	9.460	406967.771540		
2188			141626.173	43029.130	13.399	576547.312870		
2186			141630.508	43033.570	4.697	202128.678290		
6037			141630.870	43033.941	1.257	54093.663837		
2353			141631.765	43034.851	3.563	153333.174113		
倍面積							552.878409	m ²
面積							276.4392045	m ²
地積							276.43	m ²

地番	変更開発道路	点名	X	Y	X _{n+1} - X _{n-1}	Y _n (X _{n+1} - X _{n-1})		
2348			141633.983	43037.745	6.255	269201.094975		
2361			141640.688	43044.552	9.787	421277.030424		
2360			141643.770	43047.685	3.852	165819.682620		
2347			141644.540	43048.415	0.326	14033.783290		
2346			141644.096	43047.375	-1.346	-57941.766750		
2251			141643.194	43045.262	-0.955	-41108.225210		
2250			141643.141	43035.429	-0.146	-6283.172634		
2256			141643.048	43018.420	-0.128	-5506.357760		
2265			141643.013	43011.920	-5.039	-216737.064880		
2370			141638.009	43011.947	-4.965	-213554.316855		
2294			141638.048	43019.079	0.131	5635.499349		
2293			141638.140	43036.029	-3.615	-155575.244835		
2345			141634.433	43037.560	-4.157	-178907.136920		
倍面積							353.804814	m ²
面積							176.9024070	m ²
地積							176.90	m ²